

User's Guide

Mega Quilter™



This household sewing machine is designed to comply with IEC/EN 60335-2-28 and UL 1594

IMPORTANT SAFETY INSTRUCTIONS

When using an electrical appliance, basic safety precautions should always be followed, including the following:

Read all instructions before using this household sewing machine.

DANGER - To reduce the risk of electric shock:

- A sewing machine should never be left unattended when plugged in. Always unplug this sewing machine from the electric outlet immediately after using and before cleaning.
- Always unplug before relamping. Replace bulb with same type rated 12 V, 5 Watt.

WARNING

- To reduce the risk of burns, fire, electric shock, or injury to persons:

- Do not allow to be used as a toy. Close attention is necessary when this sewing machine is used by or near children and infirm persons.
- Use this sewing machine only for its intended use as described in this manual. Use only attachments recommended by the manufacturer as contained in this manual.
- Never operate this sewing machine if it has a damaged cord or plug, if it is not working properly, if it has been dropped or damaged, or dropped into water.
Return the sewing machine to the nearest authorized dealer or service center for examination, repair, electrical or mechanical adjustment.
- Never operate the sewing machine with any air openings blocked. Keep ventilation openings of the sewing machine and foot controller free from the accumulation of lint, dust, and loose cloth.
- Keep fingers away from all moving parts. Special care is required around the sewing machine needle.
- Always use the proper needle plate. The wrong plate can cause the needle to break.
- Do not use bent needles.
- Do not pull or push fabric while stitching. It may deflect the needle causing it to break.
- Switch the sewing machine off ("0") when making any adjustment in the needle area, such as threading needle, changing needle, threading bobbin, or changing presser foot, etc.
- Wear safety glasses.
- Always unplug sewing machine from the electrical outlet when removing covers, lubricating, or when making any other user servicing adjustments mentioned in the instruction manual.
- Never drop or insert any object into any opening.
- Do not use outdoors.
- Do not operate where aerosol (spray) products are being used or where oxygen is being administered.
- To disconnect, turn all controls to the off ("0") position, then remove plug from outlet.
- Do not unplug by pulling on cord. To unplug, grasp the plug, not the cord.

SAVE THESE INSTRUCTIONS

Table of contents

1. Introduction

Machine overview	2-3
Accessories	4
Needle chart	5

2. Operating your MEGA QUILTER™

Carrying handle	8
Soft cover	8
Electrical connection	9
Connecting the foot control	9
Controlling sewing speed	10
Foot control	10
Speed control slide	10
Bobbin winding button	11
Thread cutter	11
Needle Up/Down	11
Stitch length dial	12
Reverse lever	12
Presser foot lifter	12
Pressure dial	13
Knee lift	13
Changing the presser foot	14
Changing the needle	14
Attaching the darning plate	15
Placing a thread spool on the spool pin	15
Placing a thread cone on the spool pin	15
Bobbin winding	16

Inserting a bobbin	17
Inserting a bobbin case into the hook ..	18
To remove bobbin case and bobbin	18
Threading the machine	19
Needle threader	21
Bringing up the bobbin thread	22
Balancing the thread tension	23
Attaching the extension table	24

3. Getting started

Getting started to sew	26
Turning a corner	27
Using the Fabric guide	27
How to use the Free-motion foot	28
Quilting	29
Stitch-in-the-Ditch	29
Free-motion Stippling	30

4. Maintenance and troubleshooting

Cleaning the hook and feed dogs	32
Oiling the machine	33
Changing the light bulb	34
Troubleshooting	35-36

5. Index

Index	38-39
-------------	-------

Machine overview

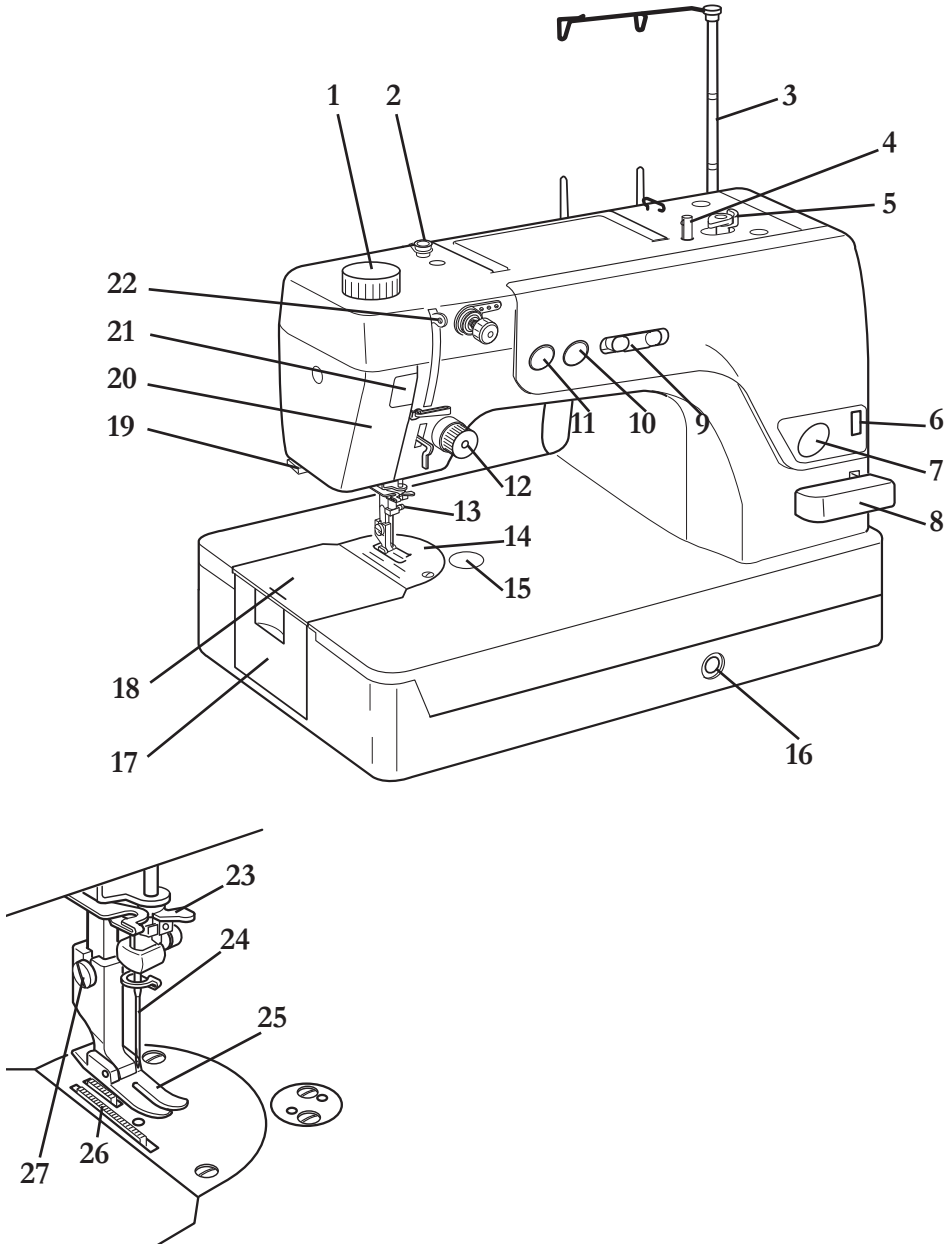

Machine overview

- | | |
|--------------------------------|---|
| 1. Pressure dial | 20. Face cover |
| 2. Bobbin winding tension disk | 21. Pressure indicator |
| 3. Thread stand | 22. Take-up lever |
| 4. Bobbin winder spindle | 23. Needle threader |
| 5. Bobbin winder stop | 24. Needle |
| 6. Stitch length indicator | 25. Presser foot |
| 7. Thread cutter button | 26. Feed dogs |
| 8. Reverse lever | 27. Set-screw |
| 9. Speed control slide | 28. Carrying handle |
| 10. Bobbin winding button | 29. Presser foot lifter |
| 11. Needle Up/Down button | 30. Thread guide for bobbin winding |
| 12. Thread tension dial | 31. Spool pins |
| 13. Needle clamp screw | 32. Machine sockets |
| 14. Needle plate | 33. Power switch |
| 15. Attachments holes | 34. Handwheel |
| 16. Knee lift socket | 35. Stitch length dial |
| 17. Bobbin case cover | 36. Socket for optional automatic thread cutter |
| 18. Hook cover plate | |
| 19. Thread cutter | |

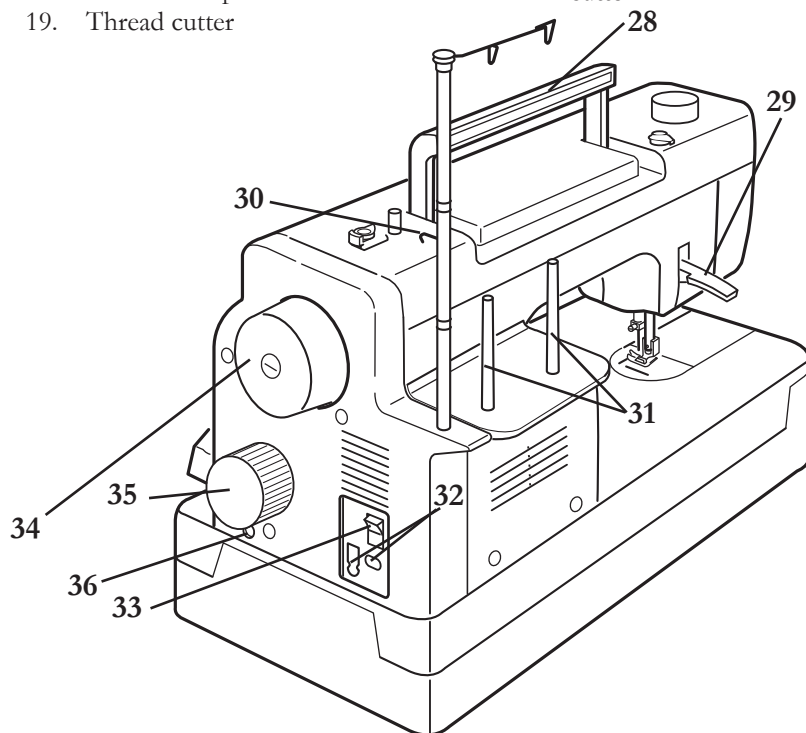

Accessories

1. Accessory box
2. Free-motion foot
3. Standard foot
4. Spool holder
5. Fabric guide
6. Screw for the fabric guide
7. Spool cap
8. Darning plate
9. Oil
10. Lint brush
11. Bobbins
12. Small screwdriver
13. Large screwdriver
14. Net
15. Needles

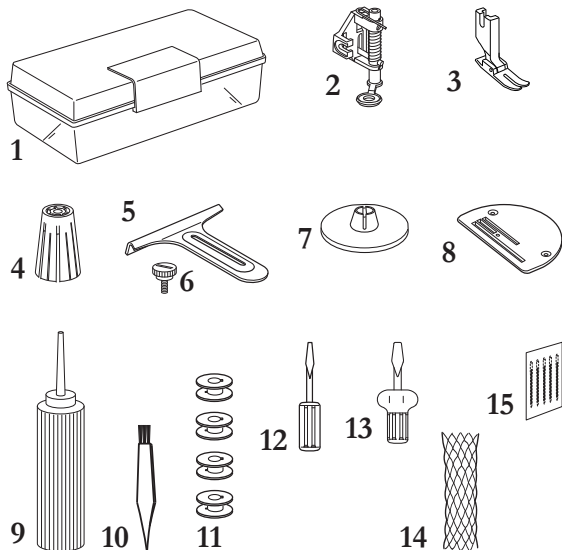

16. Soft cover
17. Knee lift

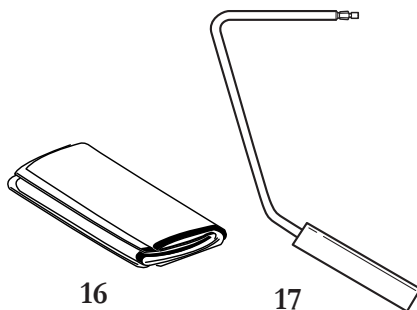

18. Extension table

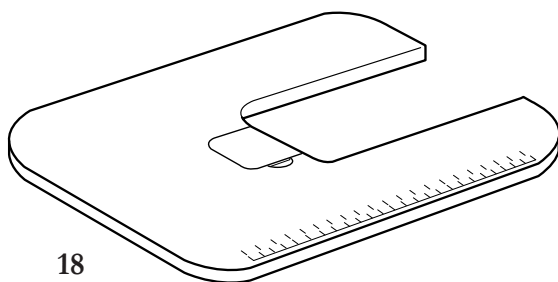

Needle chart

	Fabrics	Thread	Needle (HL x 5) size
Light weight	Crepe de chine, Voile, Lawn, Organdy, Georgette, Tricot	Fine silk, fine cotton, fine synthetic or covered polyester	9 or 11
Medium weight	Linens, Cotton, Pique, Serge, Double Knits, Percale	50 silk, 50 to 60 cotton, 50 to 60 Synthetic, cotton covered polyester	11 or 14
Heavy weight	Denim, Tweed, Gabardine, Coating, Drapery and Upholstery Fabric	30 to 50 silk, 20 to 50 Cotton, 20 to 50 Synthetic, Cotton Covered Polyester	14, 16 or 18

Some fabrics have a lot of excess dye which can cause discoloration on other fabric but also on your sewing machine. This discoloring may be very difficult or impossible to remove.

Fleece and denim fabric in especially red and blue often contain a lot of excess dye.

If you suspect that your fabric/ready-to-wear garment contains a lot of excess dye, always pre-wash it before sewing/embroidering to avoid the discoloring.

A blank sheet of lined paper with a spiral binding at the top. The paper has horizontal lines and a vertical margin line on the left side. The spiral binding is made of white plastic rings.

**Operating your
MEGA QUILTER™**



Carrying handle

Lift up the carrying handle of the MEGA QUILTER™ from behind.

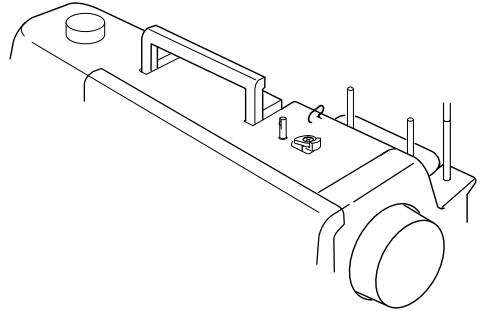

Soft cover

The soft cover, which is part of the basic equipment, protects your MEGA QUILTER™ from dust and damage while transporting.

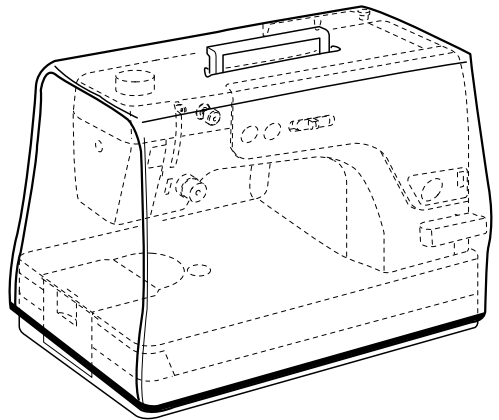

Electrical connection

 Before connecting to the power supply, make sure the voltage shown on the machine conforms to your electrical power. Always turn the power off and unplug the sewing machine from the electrical outlet when the machine is not in use.

Connect the power cord between the socket of the MEGA QUILTER™ (A) and the wall outlet.

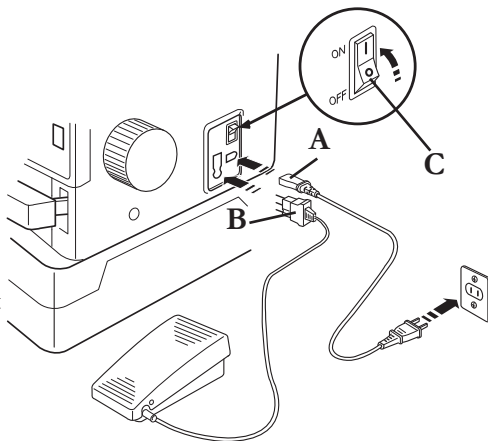

For the USA and Canada:

This sewing machine has a polarized plug (one blade wider than the other). To reduce the risk of electric shock, this plug is intended to fit in a polarized outlet only one way. If the plug does not fit fully in the outlet, reverse the plug. If it still does not fit, contact a qualified electrician to install the proper outlet.

DO NOT modify the plug in any way!

Connecting the foot control

 Switch off the main switch.

Connect the plug of the foot control (B) to the connection socket of the MEGA QUILTER™.

Turn on the power switch (C).

Controlling sewing speed

You can control the sewing speed on your machine in two ways; with your foot control and with the speed control slide on your MEGA QUILTER™.

Foot control

On your MEGA QUILTER™ you can control the sewing speed by using your foot control. The harder you press the foot control, the faster the machine runs. If you press the foot control all the way, the machine runs at the maximum speed set by the speed control slide.

Note: Make sure you have the right type of foot control for your machine. Foot Control model YC-485 is used for the MEGA QUILTER™.

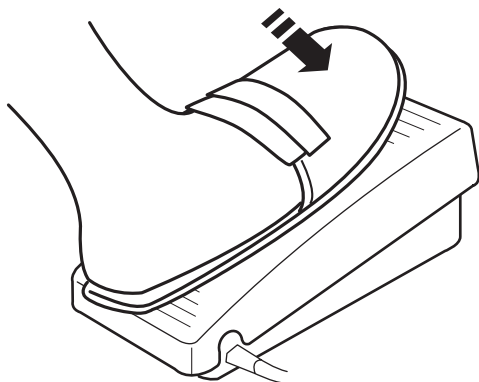

Speed control slide

With the speed control slide on your MEGA QUILTER™, you can change the sewing speed to suit your needs. For instance when making freehand quilt designs/stippling, lower the sewing speed to avoid skipped stitches.

To raise the sewing speed, slide the bar to the right.

To lower the sewing speed, slide the bar to the left.

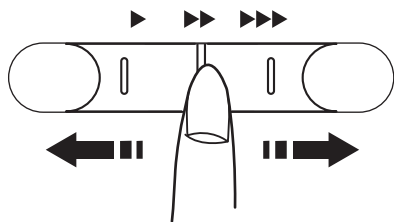

Bobbin winding button

Press the bobbin winding button on your MEGA QUILTER™ to wind the bobbin. The light above the button will light up while you are winding the bobbin. When the bobbin is full, the MEGA QUILTER™ will automatically stop and the bobbin light will be turned off. Alternatively, press the button again to stop bobbin winding.

Note: With your MEGA QUILTER™ you can wind the bobbin while sewing.

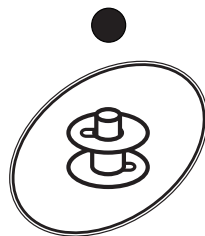

Thread Cutter

The thread cutter button trims the top and bobbin thread.

After trimming the threads you can continue sewing without having to pull the bobbin thread to the top.

Note: If you are using a thread thicker than 30 wt, use the thread cutter on the side. You cannot use the foot control or the Needle Up/Down while you are trimming the threads.

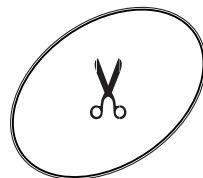

Needle Up/Down

The Needle Up/Down function is useful when you are turning a corner on your quilt. Press the Needle Up/Down button to bring the needle bar up or down. When the needle is down the red indicator above the button will light up. When the needle is up the green indicator will light up.

Your MEGA QUILTER™ will stop with the needle up or down depending on which light is switched on. After using the Thread Cutter your MEGA QUILTER™ will always stop with the needle in the up position.

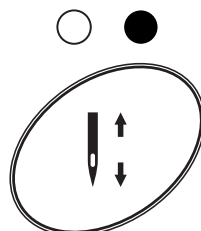
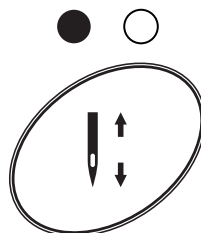

Stitch length dial

The stitch length can be adjusted by turning the stitch length dial located on the side of your MEGA QUILTER™. The stitch length can be adjusted from 0 to 6 mm. On the front of the machine there is an indicator showing the stitch length.

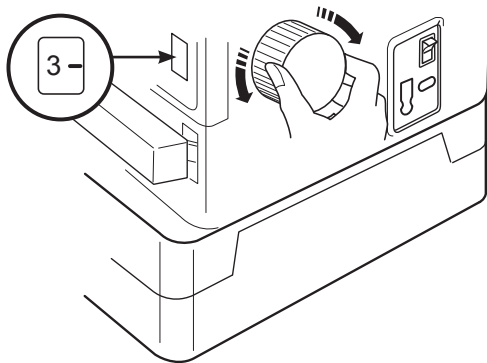

Reverse lever

Sewing in reverse will help you to secure the beginning and end of seams. When you press the reverse lever downwards, the machine will sew in reverse. The machine will only sew in reverse as long as the reverse lever is pressed down. Use either your hand or elbow to engage the reverse.

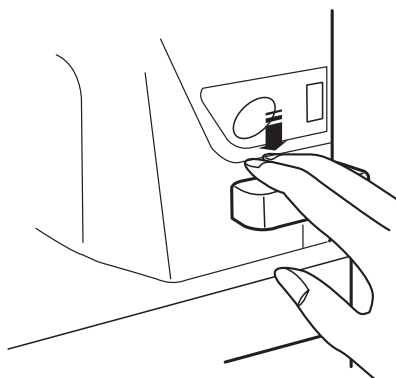

Presser foot lifter

You can raise or lower the presser foot by raising or lowering the presser foot lifter (A). You can also raise the foot to the extra lift position to help you place thick material under the foot.

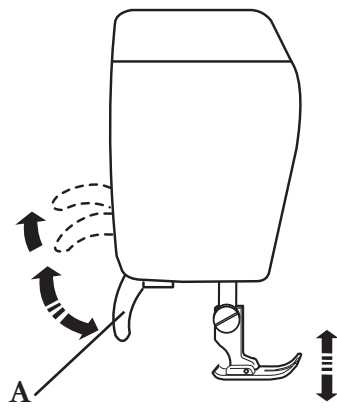

Presser foot pressure dial

Turn the pressure dial to adjust the pressure of the presser foot when sewing on different thicknesses of fabric.

For heavy fabrics or when sewing on several layers of fabric, you should raise the pressure. When sewing on thin fabric you should lower the pressure. For regular sewing set the pressure to 3. Set the pressure to "0" for free motion.

Note: Do not reduce the pressure lower than "0".

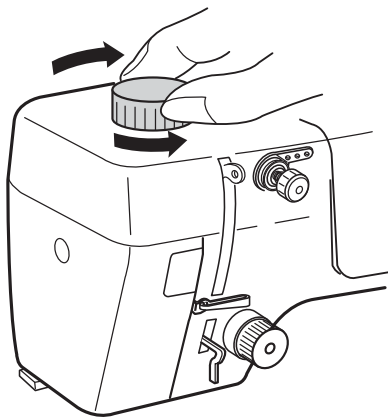

Knee lift

Your MEGA QUILTER™ is provided with a knee lift for regulating the presser foot height. It is especially useful when you need both of your hands to guide the fabric.

1. Insert the knee lift by matching the ribs on the knee lift (A) with the notches in the knee lift socket.
2. Push the knee lift with your knee sideways to raise and lower the presser foot. To remove the knee lift, pull it gently out of the hole.

Note: Avoid touching the knee lift while sewing, as the fabric will not be fed smoothly.

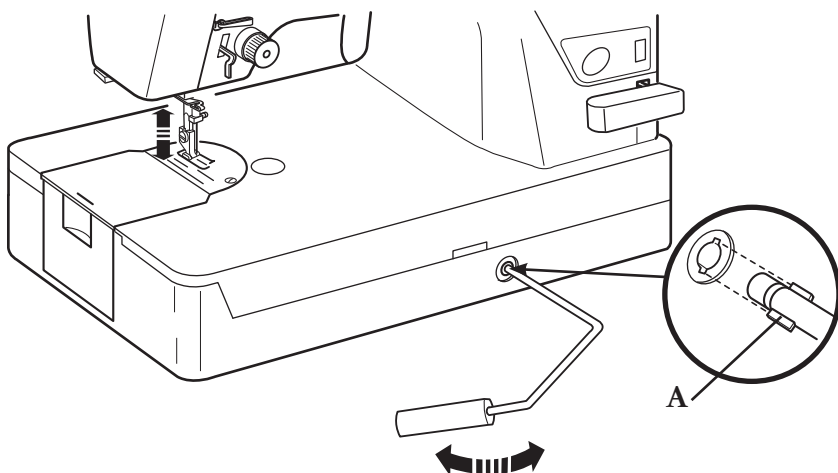

Changing the presser foot

 **Switch off the main switch and unplug the machine.**

1. Raise the presser foot lifter. Loosen the setscrew (A) with the large screwdriver.
2. Choose the proper foot and insert it from the bottom.
3. Tighten the set screw with the large screwdriver to secure the foot.

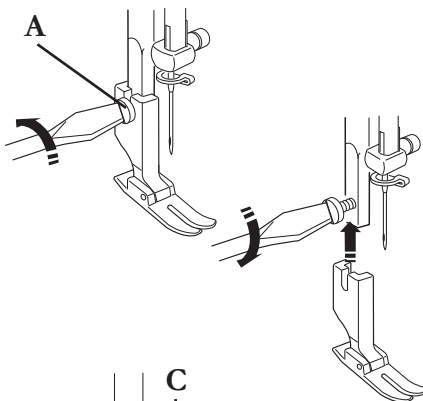

Changing the needle

 **Switch off the main switch and unplug the machine.**

1. Lower the presser foot.
2. Using the large screwdriver, turn the needle clamp screw (C) counter-clockwise.
3. Loosen the screw and remove the needle from the needle clamp (B).
4. Insert a new needle into the needle clamp (B). Make sure that the flat side is to the right. Push the needle as far as it will go and then tighten the clamp screw (C) firmly.

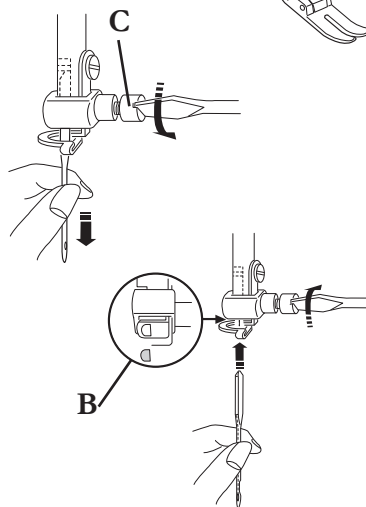

Note: Use an HL x 5 needle.

To check for a good needle

Put the flat side of the needle onto something flat (needle plate, glass etc.).

The gap between the needle and the flat surface should be consistent.

Never use a blunt needle. A damaged needle can cause permanent snags or runs in knits, fine silks and silk like fabrics.

Note: Check the needle frequently for barbed or blunted points.

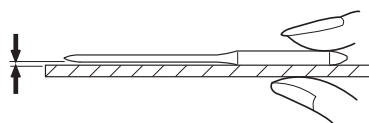

Attaching the darning plate

If you want to feed the fabric free motion, for instance when stippling, you should use the darning plate (A) that has been provided with your MEGA QUILTER™.

To attach the darning plate you should start by raising the presser foot lifter. Raise the needle to its highest position by pressing the Needle Up/Down button twice.



Switch off the main switch and unplug the machine.

Remove the two set screws and remove the standard needle plate. Put the darning plate in place and secure it with the two set screws.

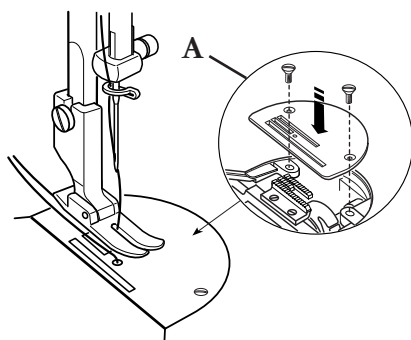

Placing a thread spool on the spool pin

Place a spool of thread on the spool pin and put a spool cap firmly against the spool. The thread should come off the spool as shown in the picture.

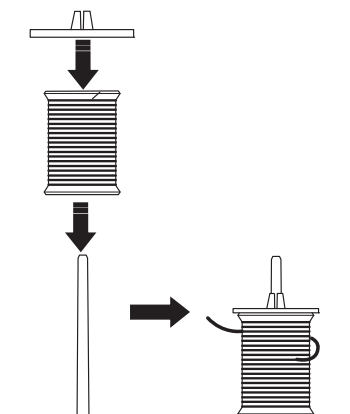

Placing a thread cone on the spool pin

If you are using a large thread cone, use a spool holder to hold the cone in place. Put the spool holder (B) on the spool pin, then place the thread cone on the spool holder.

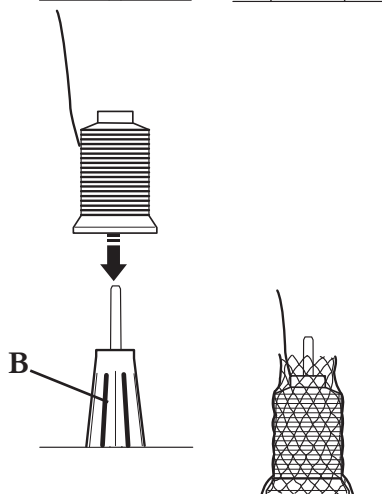

Note: If the cone is wobbly when sewing, cover the thread cone with the net that comes with the machine.

Bobbin winding

1. Pull the thread stand up as far as it will go and turn it around until it clicks into position.
2. Pass the thread through the guide (A) on the thread stand from behind.
3. Pass the thread through the second thread guide (B).
4. Pass the thread under the bobbin winding tension disk (C).
5. Thread through the hole (D) in the bobbin from the inside to the outside. Place the bobbin on the bobbin winder spindle by matching the slit in the bobbin with the spring on the bobbin winder spindle (E).
6. Push the bobbin winder stop to the left (F).
7. Hold the end of the thread and press the bobbin winding button. Press the bobbin winding button again to stop the bobbin when it has made several turns, and cut the thread close to the hole in the bobbin.
8. Press the bobbin winding button again. The MEGA QUILTER™ will stop automatically when the bobbin is full and the bobbin winder stop will return to the original position.
9. Cut the thread with scissors. Remove the bobbin from the bobbin winder spindle.

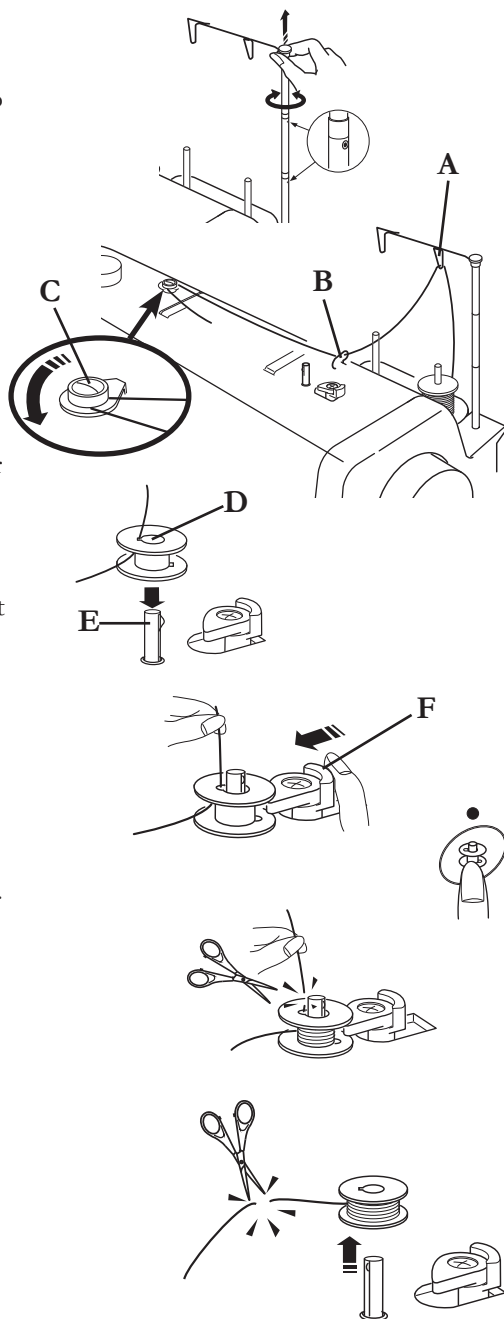

Note: The MEGA QUILTER™ has an exclusive motor for bobbin winding, which allows you to wind a bobbin while sewing.

Inserting a bobbin

1. Place a bobbin in the bobbin case making sure the thread winds clockwise.

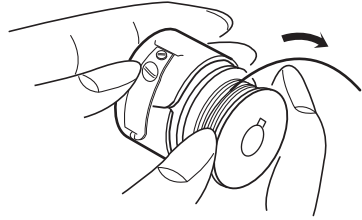

2. Draw the thread through the slit (A) of the bobbin case.

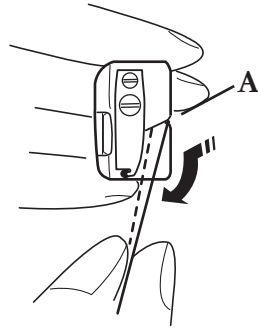

3. Continue to draw the thread under the tension spring and through the opening (B).

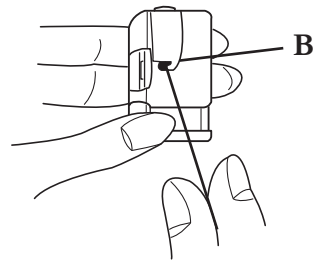

4. Pull about 4" (10 cm) of thread.

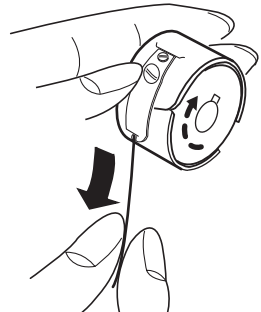

Inserting a bobbin case into the hook



Switch off the main switch and unplug the machine.

1. Lift the hook cover plate (A) up and remove it. Open the bobbin case cover (B).
2. Holding the latch on the bobbin case (see picture), position the bobbin case into the hook aligning the slot with the rib. The bobbin case should lock into place when the latch is released.
3. Close the bobbin case cover and the hook cover plate.

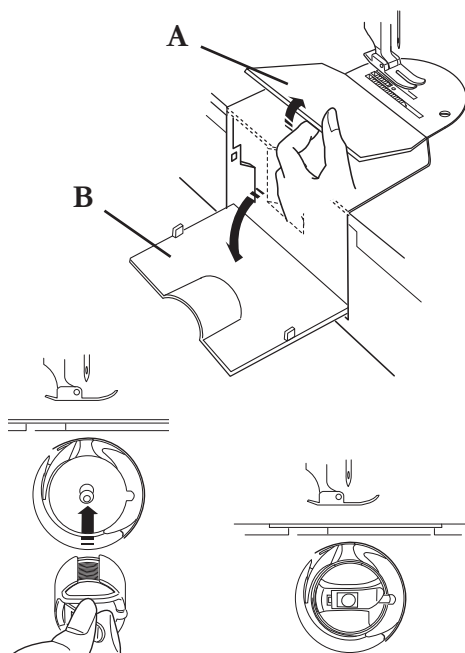

To remove bobbin case and bobbin



Switch off the main switch and unplug the machine.

1. Raise the needle and presser foot. Lift the hook cover plate (A) up and remove it. Open the bobbin case cover (B).
2. Take the bobbin case out of the hook by pulling the latch and taking the bobbin case straight out of the hook.
3. To remove the bobbin, release the latch, and the bobbin will be released from the bobbin case.

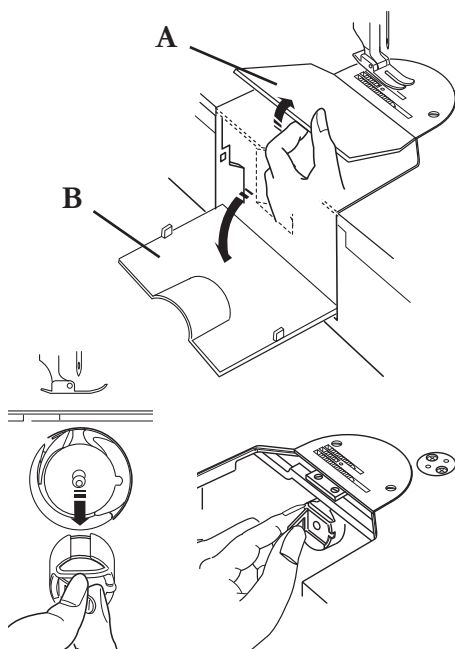

Threading the machine

1. Raise the presser foot lifter. Press the Needle Up/Down button twice to raise the needle to its highest position.



Switch off the main switch and unplug the machine.

2. Place a thread spool on the spool pin.
3. Pass the thread through the guide on the thread guide bar (A) from behind.
4. Pass the thread through two holes in the thread guide plate (B), then draw the thread between the pre-tension disks (C).

Note: The standard pre-tension dial setting is for the screw head sinks about 4 mm (1/8" to 3/16").

If you find that the thread is too loose while sewing, you can pass the thread through all three holes in the guide plate (B).

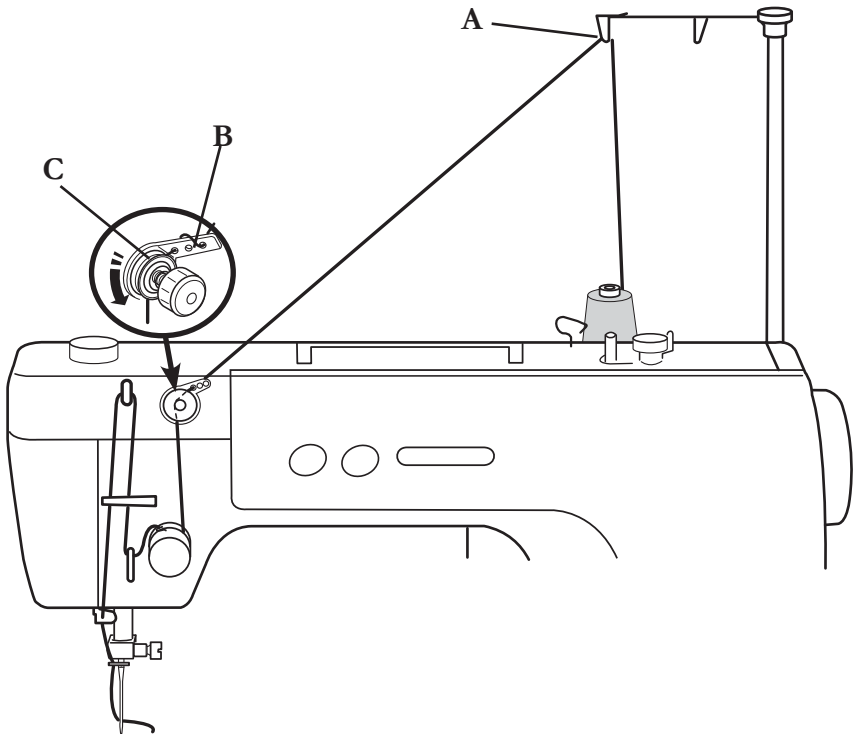

5. Holding the thread with both hands, draw the thread down and around the tension dial from right to left.

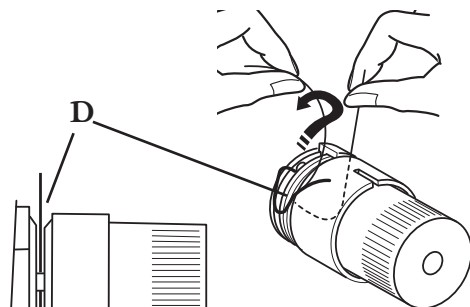

6. Pull the thread up to insert it between the tension disks (D) and pass it over the tail of the check spring. Pull the thread down over the loop of the check spring (E).

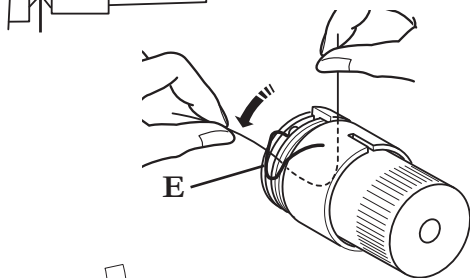

7. Draw the thread under the thread guide (F) and through the second thread guide (G). Pass the thread through the eye of the take-up lever (H).

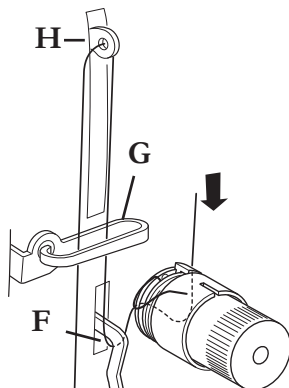

8. Pass the thread through the thread guide (G) again.

9. Slip the thread into the thread guide (I).

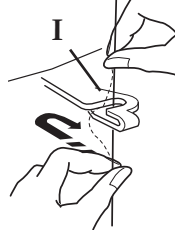

10. Draw the thread down to the needle bar thread guide (J), then pass the thread through the needle eye.

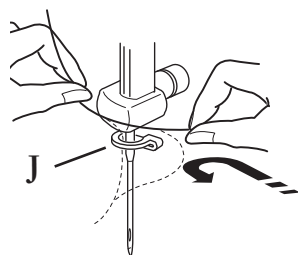

Needle threader

To make threading the needle easier and quicker you have been provided with a needle threader.

1. Lower the presser foot. Press the Needle Up/Down button twice to raise the needle to its highest position.

 **Switch off the main switch and unplug the machine.**

2. Move the needle threader completely downwards and turn it towards the needle so that the small hook goes through the needle eye from the right.
3. Pull the thread from behind around the guide (A) and under the hook (B).
4. Hold the end of the thread with your hand while pulling up the thread lightly.
5. Turn the knob (see picture). This will draw a thread loop through the needle. Release the threader knob slowly and then pull the thread loop to the right.

Note: When using the threads below the needle threader may not work.

Needle size	Thread size
9/65	12, 20, 30, 40, 50, 60
11/75	12, 20, 30
14/90	12, 16, 20, 30
16/100	12, 20, 30

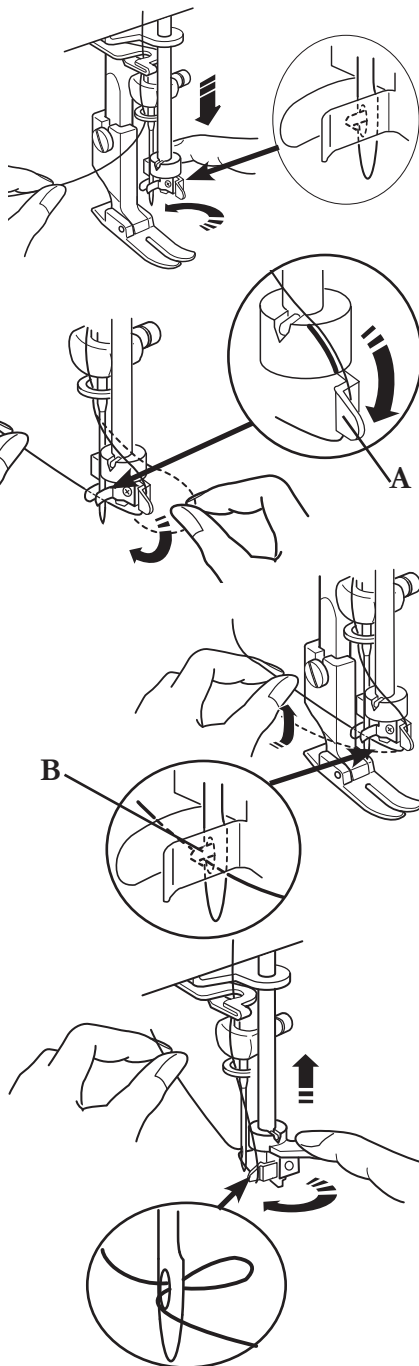

Bringing up the bobbin thread

1. Hold the thread with your left hand.
2. Turn the switch on. Press the Needle Up/Down button twice to pick up the bobbin thread.



Switch off the main switch and unplug the machine.

3. Bring the bobbin thread up by pulling the needle thread.
4. Pull 4" (10 cm) of both threads back and under the presser foot.

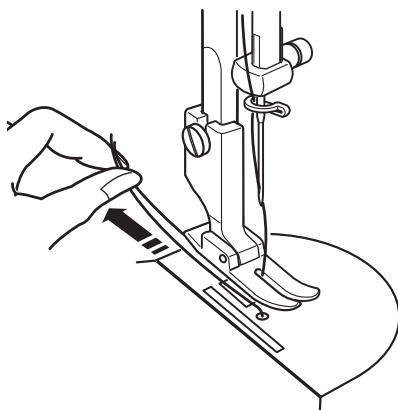
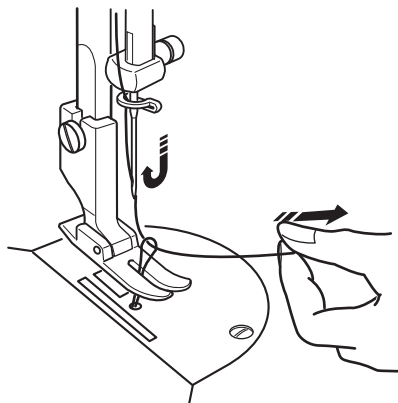
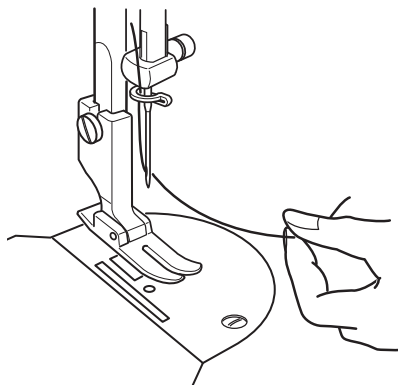

Balancing the thread tension

The thread tension should be adjusted depending on the sewing materials, layers of fabric and sewing method. Set the required thread tension with the thread tension dial.

Balanced tension:

The ideal straight stitch has threads locked between two layers of fabric, as shown in the picture.

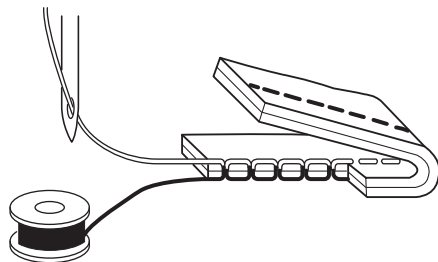

Thread tension is too tight:

If the needle thread tension is too high the threads are interlaced above the top fabric. Loosen the needle thread tension by turning the dial to the left.



Thread tension is too loose:

If the needle thread tension is too low the threads are interlaced below the lower fabric. Tighten the needle thread tension by turning the dial to the right.

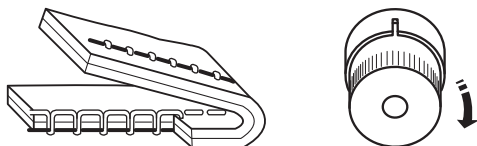

Attaching the extension table

Your MEGA QUILTER™ has been provided with an extension table to make it easier for you to work with large pieces of fabric.

On the underside of the extension table there are four table legs. Pull them all up to support the table.

Turn the table around and slide the extension table in the direction of the arrow in the picture, onto the machine.

Note: There is small door on the extension table which makes it possible for you to change the bobbin thread without having to remove the table. You can also store the knee lifter on the backside of the extension table.

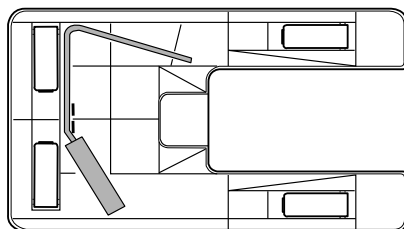
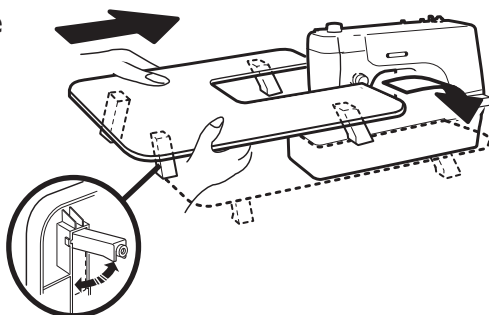

Getting started



Getting started to sew

Before you start to sew, try test stitching with the same thread and with the same type of fabric.

1. Raise the presser foot and place the fabric under the foot.
2. Lower the presser foot and pull the threads towards the back.
3. Set the speed control slide to slow until you get used to the speed. Press down on the foot control.
4. Gently guide the fabric along the seam guide letting the fabric feed by itself.
5. Check the sewing result and adjust the needle thread tension if needed.

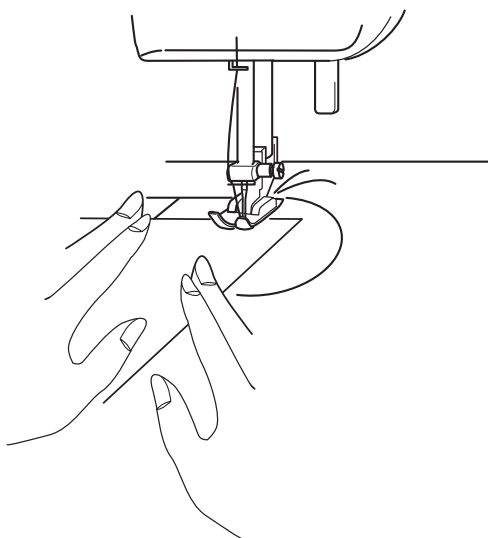
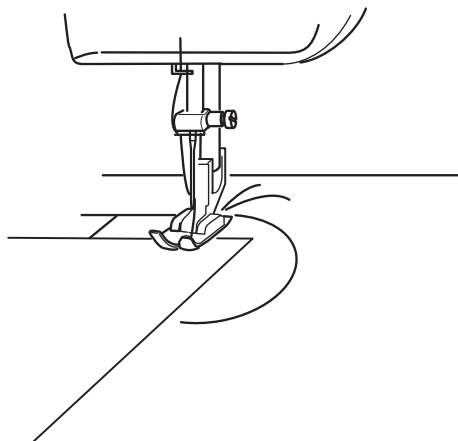

Note: To lock the beginning of the seam, sew a few stitches forward, then sew a few stitches in reverse, then sew forward again. You can also pull the bobbin thread to bring the needle thread to the wrong side of the fabric. Tie the threads together. Trim the remaining threads.

Turning a corner

1. Stop the machine a few stitches before the end of the seam.
2. Press the Needle Up/Down button a few times until the needle is at the end of the seam.
3. Raise the presser foot.
4. Pivot the fabric around the needle to change the sewing direction.
5. Lower the presser foot and continue sewing in the new direction.

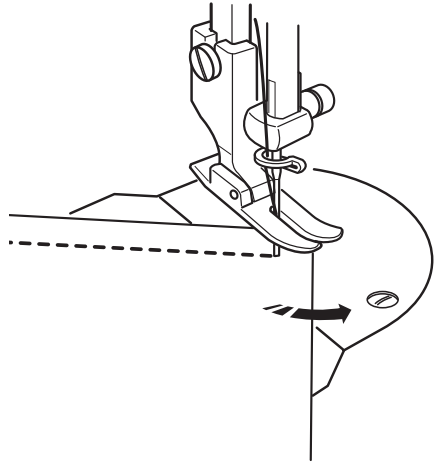

Using the Fabric Guide

1. Attach the fabric guide to the attachment hole with the screw.
2. Adjust the position of the fabric guide and tighten the screw.
3. Place the fabric with its edge against the fabric guide.
4. Lower the presser foot and start to sew.

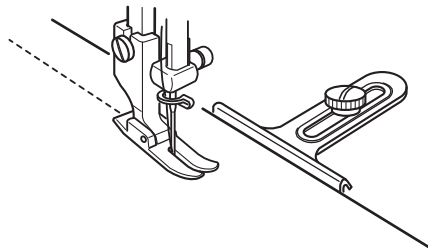
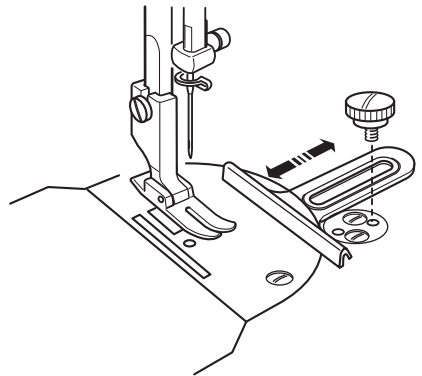

How to use the Free-motion foot

The Free-motion foot can be used when stippling or freehand quilting your quilt.

1. Replace the standard needle plate with the darning plate (A).
2. Attach the Free-motion foot to the presser bar with the lever over the needle clamp.
3. Start to sew. Always test sew on a piece of scrap fabric.
4. Adjust the speed control to a comfortable speed for you.

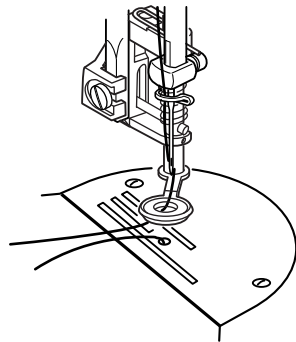
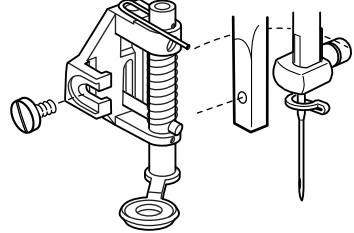
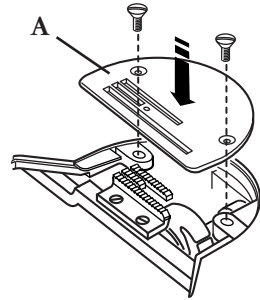

Quilting

Quilting is a traditional technique. A quilt consists of three layers, two layers of fabric with a layer of batting sandwiched between.

Stitch-in-the-Ditch

One way to hold the quilt top, batting and backing together is using the "Stitch-in-the-Ditch" method of quilting. Stitching-in-the-ditch means stitching in the seams in the quilt blocks.

- Prepare your quilt by pin basting through all layers with safety pins – starting from the center of your quilt and working outward. Place a pin about every 6 – 8 inches (15–20 cm).
- To begin quilting, start sewing from the middle of the quilt and continue sewing outward. Starting from the center and sewing outward will help keep layers in place. Plan which seams you will actually stitch in. This stitching will not only hold the quilt together it will also create the pattern on the quilt back. You do not need to follow every seam in the quilt, sew every 3 – 4 inches to keep the quilt in place. Of course you can sew more to create a more decorative pattern for the back.

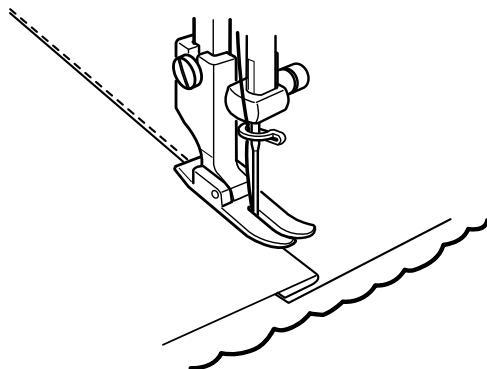

Note: Always test sew on scrap fabric before starting to sew to make sure your stitching is balanced before you start quilting your piece.

Free-motion Stippling

Free-motion Stippling not only keeps the top, batting and backing together, but it also adds texture and interest to your quilt.

1. Replace the standard needle plate with the darning plate (A).
2. Attach the extension table to your MEGA QUILTER™.
3. Attach the Free-motion foot.
4. Prepare your quilt by pin basting through all layers with safety pins – starting from the center of your quilt and working outward. Place a pin about every 10–12 inches (25–30 cm).
5. Practice stippling on scraps of fabric and batting. When the feed dogs are covered, you move the fabric to determine the stitch length. Sewing with a constant speed will help to keep the stitches even. You may lower the speed control slide in order to help make the stitches even.
6. Begin near the center of your quilt. Take one stitch and pull the bobbin thread to the top of the quilt. Take a few stitches right next to one another to secure the threads. Now move the quilt so that your stitching creates scrolls and swirls.

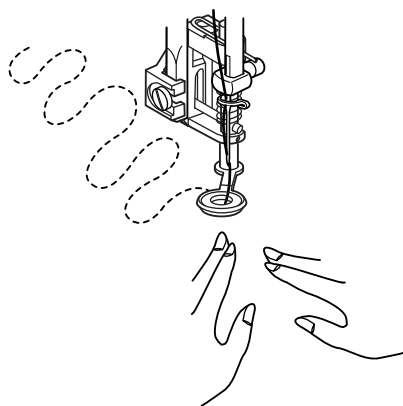
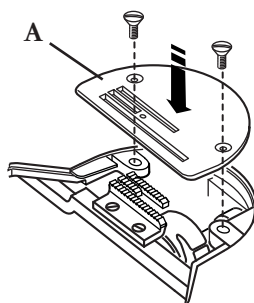

Maintenance and troubleshooting



Cleaning the hook and feed dogs



Switch off the main switch and unplug the machine.

1. Remove the needle and presser foot.
2. Remove the hook cover plate (A) and open the bobbin case cover (B).
3. Loosen the set screws (C) and remove the needle plate.

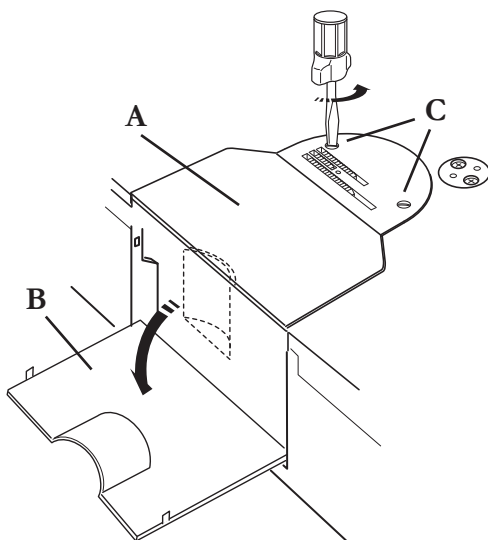

4. Clean the hook (D) and feed dogs (E) with the lint brush.
5. After cleaning the MEGA QUILTER™, attach the needle plate, needle and presser foot.

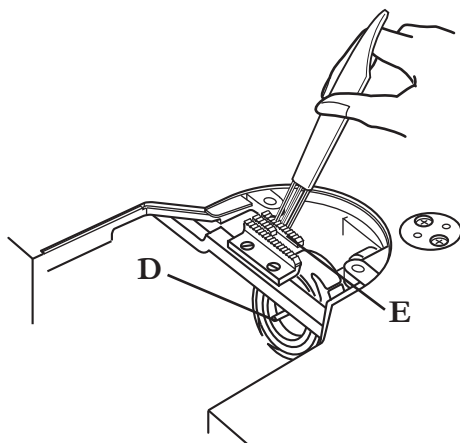

Oiling the MEGA QUILTER™



Switch off the main switch and unplug the machine.

Clean the area first.

Add two or three drops of oil in the places shown (A), (B) and (C). You should only use the MO 70 sewing machine oil for your MEGA QUILTER™.

If you use the machine frequently you should oil the machine once a day.

Use a soft, dry cloth to remove excess oil.

When you oil the hook (B), remove the bobbin case from the hook.

After oiling, sew on a piece of scrap fabric to absorb excess oil.

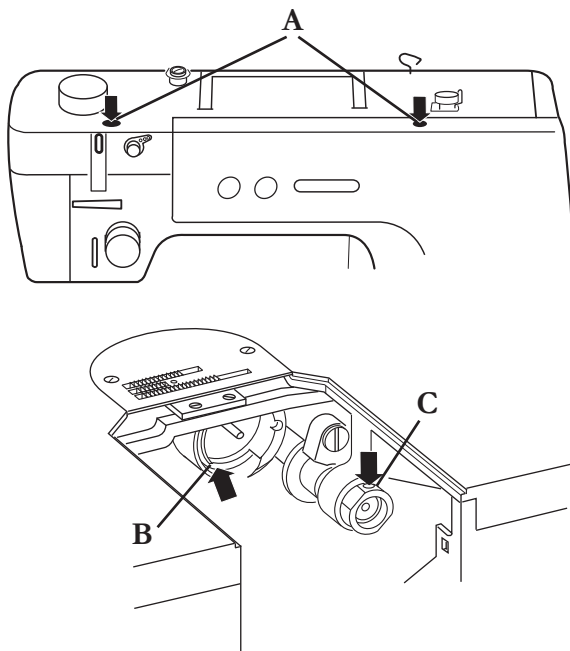

Changing the light bulb

 Switch off the main switch. If you have used the machine, wait for the lamp to cool before touching it.

Removal:

Remove the setscrew (A).
Remove the face cover (B).
Pull out the light bulb (C) from the lamp socket (D).

Insertion:

Insert a new light bulb into the opening of the socket (D).
Attach the face cover (B) with the setscrew.

Note: Replace the bulb with the same type, rated 12 V, 5 W.

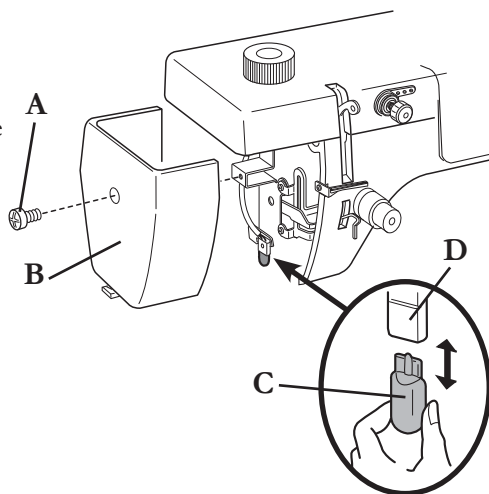

Troubleshooting

The needle thread breaks

- The needle thread is not threaded properly (page 19-21).
- The needle thread tension is too tight (page 23).
- The needle is bent or blunt (page 14).
- The needle is incorrectly inserted (page 14).
- The needle thread and the bobbin thread are not set under the presser foot when starting sewing (page 22).
- The threads were not pulled to the rear after sewing (page 22).
- The thread is too heavy or too fine for the needle (page 5).

The bobbin thread breaks

- The bobbin thread is not threaded properly in the bobbin holder (page 17).
- Lint has collected in the bobbin holder (page 32).
- The bobbin is damaged and does not turn smoothly (change the bobbin).

The needle breaks

- The needle is incorrectly inserted, bent or blunt (page 14).
- The needle clamp screw is loose (page 14).
- The threads were not pulled to the rear after sewing (page 22).
- The needle is too fine for the fabric being used (page 5).
- The needle and/or threads are not suitable for the work being sewn (page 5).

The machine skips stitches

- The needle is incorrectly inserted, bent or blunt (page 14).
- The needle thread is not threaded properly (page 19-21).
- A poor quality needle is used (change the needle)
- The needle thread tension is too tight (page 23).
- The needle and/or fabrics are not suitable for the work being sewn (page 5).

Seam puckering

- The needle thread is not threaded properly (page 19-21).
- The needle is too heavy for the fabric being sewn (page 5).
- The stitch length is too long for the fabric (page 12).
- The needle thread tension is too tight (page 23).

The cloth is not fed smoothly

- The feed dog is packed with lint (page 32).
- The stitches are too fine (page 12).

Loops on the seams

- The needle thread tension is too loose (page 23).
- The needle is too thick or too fine for the fabric (page 5).

The machine does not sew or run

- The machine is not plugged in (page 9).
- Thread has been caught in the hook race (page 32).

The machine is noisy

- Thread has been caught in the hook race (page 32).
- Lint has built up in the hook race or bobbin holder (page 32).
- The machine needs oiling (page 33).

Important notes: Before changing presser foot and needle you must turn the main switch off. Do not attempt to sew without fabric under the presser foot. When leaving the machine, even for only a short time, switch off the main switch. This is important if there are any children nearby.

Index



Index

- A**
Accessories..... 4
Accessories box 4
Attaching the darning plate 15
Attaching the extension table..... 24
Attaching the knee lift 13
- B**
Balancing the thread tension 23
Bobbin4, 11, 16-18
Bobbin case 17-18
Bobbin winding 11, 16-17
Bobbin winding button..... 11
Bobbin case cover 18
Bringing up the bobbin thread..... 22
Brush.....4, 32
Bulb 34
- C**
Carrying handle..... 8
Changing the light bulb..... 34
Changing the needle 14
Changing the presser foot 14
Cleaning the hook and
feed dogs 32
Connecting the foot control..... 9
- D**
Darning plate.....15, 28
- E**
Electrical connection 9
Extension table..... 24
- F**
Fabric Guide.....27
Feed dogs..... 32
Foot control9-10
Free-motion foot.....4, 28
Free-motion stippling 30
- G**
Getting started to sew 25
- H**
Hook 18, 32-33
Hook cover plate.....2-3, 18, 32
- I**
Inserting a bobbin 17
Inserting a bobbin into the hook..... 18
- K**
Knee lift.....13, 24
- L**
Light bulb 34
- M**
Machine overview2-3
Maintenance..... 31
Main switch2-3, 9, 14-15, 18-19, 21-22, 32-34
- N**
Needle2-5
Needle chart..... 5
Needle plate 2-3, 14
Needle size 5
Needle treader 21
Needle Up/Down 11

- Oil**4, 33
Oiling the machine..... 33
Overview2-3
- Placing a tread cone on the**
spool pin..... 15
Pressure dial 13
Presser foot 2-3, 14
Presser foot lift 12
Problems and solutions..... 35-36
- Quilting** 29
- Raise presser foot**12, 13
Remove the bobbin case
and bobbin 18
Reverse lever 12
Reverse sewing..... 12
- Sewing speed** 10
Soft cover 8
Speed control slide..... 10
Spool pin 2-3, 15
Spool cap4, 15
Standard accessories 4
Stippling.....30
Stitch balance 23
Stitch-in-the-ditch 29
Stich length..... 12
Stitch length dial..... 12
- Thread cone**4, 15
Thread cutter 2-3, 11
Thread guide 2-3, 16-17, 19-20
Thread spool..... 15
Thread tension..... 19-20, 23
Threading the machine..... 19-20
Troubleshooting 35-36
Turning a corner..... 11, 27
- Using the Fabric guide**..... 27

We reserve the right to change the machine equipment and assortment of accessories without prior notice, or make modifications to the performance or design.

Such modifications, however, will always be to the benefit of the user and the product.

Intellectual property

HUSQVARNA, VIKING, the "Crowned H-mark", KEEPING THE WORLD SEWING & Design and MEGA QUILTER are registered trademarks or trademarks of VSM Group AB or its licensor.



Please note that on disposal, this product must be safely recycled in accordance with relevant National legislation relating to electrical/electronic products. If in doubt please contact your retailer for guidance.



VSM Group AB • SE-561 84 Huskvarna, Sweden
www.husqvarnaviking.com